

APPLICATION GUIDELINES

RIBBED FERRULE

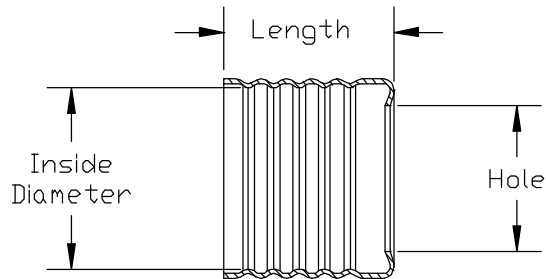

General information

The purpose of the rib ferrule is to provide a barrier for the hose to be compressed against from the force provided by the expansion of the coupling's tail. The I.D. (inside diameter) of the rib ferrule should be the same size or slightly larger than the O.D. (outside diameter) of the hose. As long as the range of expansion of the coupling's tail will provide enough hose compression, a larger rib ferrule may be used. Keep in mind that the hose will appear flared out where it is expanded out to the I.D. of the larger rib ferrule. The hole size of the ferrule must be large enough to allow for the expansion of the coupling's tail.